

 **Intended Use**

Designed for the collection and preservation of swab specimens of SARS-CoV-2, as well as sampling swabs of other pathogens.

 **Product Information**

| No. | Product Name | Model | No. of Tests |
|-----|-----------------------|--|--------------|
| 1 | Sample Collection Set | SP-a-01 (inactivated, single sampling) | 48 Tests/Kit |
| 2 | | SP-b-01 (inactivated, multiplex sampling) | 48 Tests/Kit |
| 3 | | SP-a-02 (non-inactivated, single sampling) | 48 Tests/Kit |
| 4 | | | |

 **Remark**

Oropharyngeal and nasopharyngeal swabs are available for each model.



Xi'an Tianlong Science and Technology Co., Ltd.
 Address: No. 389 Zhuhong Road, Xi'an Economic & Technological Development Zone, Xi'an City, Shaanxi Province, China
 Tel: +86-29-8667 5008
 Fax: +86-29-8221 6680
<http://www.medtl.net>
 Email: info@medtl.com

Suzhou Tianlong Bio-technology Co., Ltd.
 Address: 5F, Block 7, Northwest Zone of Nanopolis Suzhou, No.99 Jinji Lake Avenue, Suzhou Industrial Park, Suzhou City, Jiangsu Province, China
 Tel: +86-512-6252 7726
 Fax: + 86-512-6295 6337
<http://www.medtl.cn>



The right to change product design and specifications are reserved by Tianlong. Printed in Sept. 2021 (First Edition)



SAMPLE COLLECTION SET



SAFE

EFFICIENT

STABLE

Bring Technology to Life!

Sample collection - the first step for nucleic acid testing

Nucleic acid testing is the recommended initial diagnostic method for COVID-19, and sample collection is the first step for nucleic acid testing. The accuracy of the final results can be impacted by the product quality of sample collecting consumables and the operating standardization of the procedures.

TIANLONG SAMPLE COLLECTION SET

Tianlong sample collection set include collection tubes with Specimen transport media (STM) (inactivated and non-inactivated) and swabs (oropharyngeal and nasopharyngeal) applicable for single sample collection or multiplex sampling. Tianlong unique STM was designed and developed with its special formula offering a biological buffering system that can maintain normal biological pH value, inhibit the nuclease activity of DNase and RNase, and prevent sample nucleic acid degradation. The inactivated STM can damage the advanced structure of pathogen protein and physiological activity, and reduce the infectious and pathogenic ability.



Reliable Quality - International Registrations and Certifications

Tianlong sample collection set has been approved and certified in China, EU, US, UK and other countries and regions.

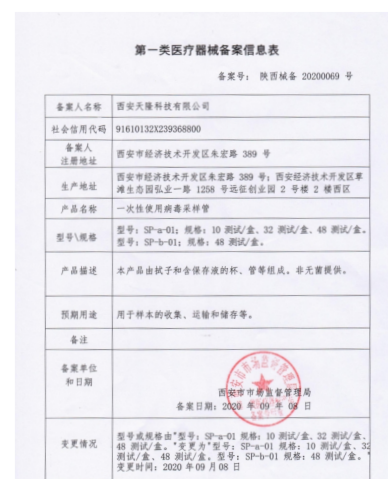
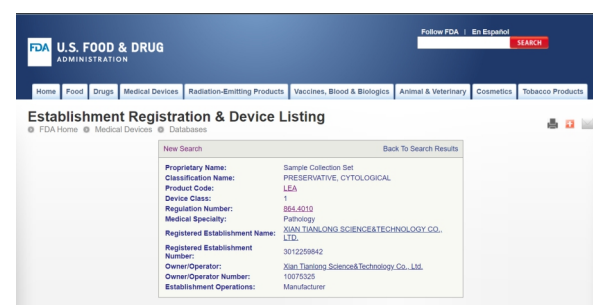

Features

Flexible

Various options for your needs: Inactivated and non-inactivated, oropharyngeal and nasopharyngeal swabs, single and multiplex collection, etc.

Safe

Simultaneous sampling and virus inactivation, to minimize the risk of infection.



Stable

Demonstrated sample stabilization, to avoid nucleic acid degradation and ensure the precise results.

Automation-ready

The collection tube is automation-ready for Tianlong automated nucleic acid workstations such as PANA9600E and PANA9600S. The single sampling tube is automation-ready for Tianlong automated sample processing system GeneMix 48. The opening and closing of the lid can also be automated, which greatly improves the efficiency of sample detection.

Procedures

Oropharyngeal swab



1 Collect the Sample:

Rub the swab up and down the posterior pharynx and bilateral tonsillar area, 3 times at least. Swab it while rotating.

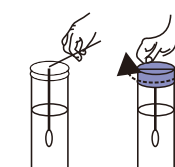

2 Package the Sample:

Insert the swab into the transport media. Bend the swab shaft to break it off. Screw the cap back onto the tube.

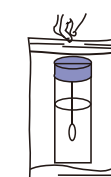

3 Sample Storage:

Insert the tube into a transport bag and seal. Samples should be shipped after collection as soon as possible. Keep and transport samples at 2-8°C.

Nasopharyngeal swab

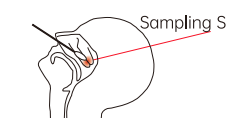

1 Collect the Sample:

Slowly insert the swab along the bottom of the nasal passage. When it reaches the back wall of the nasopharyngeal cavity, gently rotate it once, and then slowly remove the swab. Using 1 swab for both nostrils of 1 person is allowed.

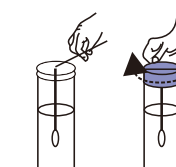

2 Package the Sample:

Insert the swab into the transport media. Bend the swab shaft to break it off. Screw the cap back onto the tube.

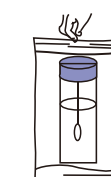

3 Sample Storage:

Insert the tube into a transport bag and seal. Samples should be shipped after collection as soon as possible. Keep and transport samples at 2-8°C.